

2.5C

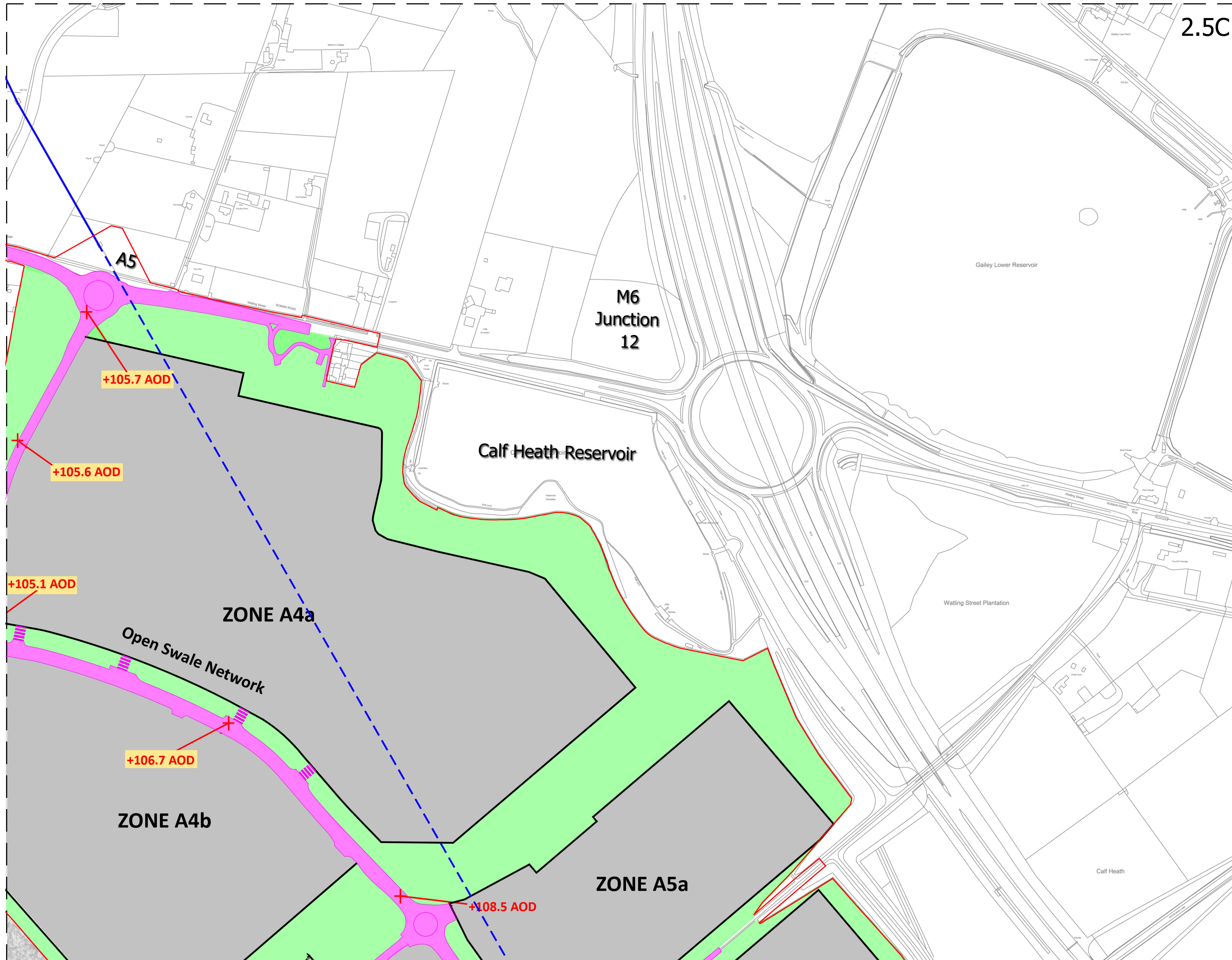

- +000.0 AOD Updated AOD
- Order Limits
- Zone A1-A7 - Development Areas
- Zone B - Rail terminal, container storage, Parking area and associated welfare facilities.
- Zone C - Rail corridor including new rail lines and landscaping.
- New on-site road infrastructure and access.
- Landscaping
- Estate Management Offices / Amenity and Welfare Facilities
- Residential Property and Curtilage
- Plot Access Points through Green Infrastructure. (precise location and extent to be approved at time of submission of details for approval post DCO approval)
- Canal crossings to be demolished
- Existing Overhead Electricity Cables
- Existing Overhead Electricity Cables to be re-routed underground

Limits of Deviation shown on works plan and set out in Article 4 of the DCO

Note:  
All AOD levels shown for the new on-site road infrastructure are subject to a vertical deviation of 0.5 metres upwards or downwards



Project  
THE WEST MIDLANDS RAIL FREIGHT INTERCHANGE ORDER 2020

Drawing Status  
SUBMISSION

Drawing Title  
PARAMETER PLAN  
DEVELOPMENT ZONE PLAN - SHEET 3

Regulation 5 (2) (o)	Document 2.5C
-------------------------	------------------

Drawn SM	Date MARCH 2018	Scale 1/2500	Reviewed PMJS
Drawing No. 4990 - 02003	Rev. 09		